

Safety switch 250 A

Series 8537/7



- > High level of corrosion resistance in external components
- > 3-pole safety switches 250 A
- > Motor switching capacity AC-3 and AC-23 acc. to IEC 60947-3, EN 60947, DIN VDE 0660 Part 107
- > With or without load-shedding contact
- > Positive opening operation of the main contacts
- > Isolating characteristics acc. to IEC/EN 60947-1 / -3
- > Rotary actuator with clear switching position
- > Marked with signal orange label "Safety Switch"
- > Padlockable in "OFF" position with padlocks



10102E00



Safety switches ensure that the machines and installations are inevitably disconnected from the energy supply during cleaning and repair work. The usual preparatory work that may only be carried out by qualified electricians can be omitted. The safety switches can be used with both conventional drives and drives controlled by frequency converters.

In addition to use with conventional drives, the safety switches are also suitable for use with drives controlled by frequency converters. When doing so, ensure that an auxiliary contact with these functions (NO: ON delayed; OFF leading) is used. The required time parameters must also be checked. The area of application lies in the frequency range from 5 to 400 Hz; the rated operating current must be adjusted accordingly.

	ATEX / IECEx					
	0	1	2	20	21	22
Zone						
For use in		x	x		x	x

WebCode 8537A

Safety switch 250 A

Series 8537/7

Selection Table

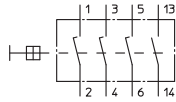
Version	Schematic	Cable entries	Order number	Weight kg
250 A, 3-pole  01683E00	 08787E00	2 x 8161/5-M63 1 x 8161/5-M20	8537/7-712-7000	90.000

Note

Further versions (160, 315, 400, 500 A) on request

Explosion Protection

Global (IECEx)

Gas and dust

IECEx PTB 06.0073
 Ex de eb ia [ia Ga] ib IIC T6...T4 Gb
 Ex tb IIIC T80°C ... T130 °C Db

Europe (ATEX)

Gas and dust

PTB 02 ATEX 1109 (certificate Series 8220/.50)
 Ⓢ II 2(1) G Ex de eb ia [ia Ga] ib IIC T6...T4 Gb
 Ⓢ II 2 D Ex tb IIIC T80°C ... T130 °C Db

Certifications and certificates

Certificates

IECEx, ATEX, others on request

Technical Data

Ambient conditions

Ambient temperature range

-20 ... +40 °C

Mechanical data

Degree of protection

IP65

Enclosure material

Ex d enclosure: sheet steel, powder coated, cover: light metal
 Ex e enclosure: galvanised sheet steel, powder coated

Enclosure cover

In switching position ON removable, in OFF position locked

Handle

Can be locked with 3 padlocks in 0-position
 Colour: Handle black, protective shroud black
 Special version: Protective handle red, protective collar yellow

Safety switch 250 A

Series 8537/7



Technical Data

Electrical data

Main contacts

Rated operational voltage	690 V AC
Rated insulation voltage	750 V
Rated impulse withstand voltage	6 kV
Rated working current	250 A
	according to IEC/EN 60947-3, DIN VDE 0660, part 107

Switching capacity

AC3		AC23	
U _e	P (3-pole)	U _e	P (3-pole)
230 V ~	75.0 kW	230 V ~	75.0 kW
400 V ~	132.0 kW	400 V ~	132.0 kW
500 V ~	160.0 kW	500 V ~	160.0 kW
690 V ~	200.0 kW	690 V ~	200.0 kW

Service life of electrical / mechanical parts	3 x 10 ⁴ / > 10 ⁵ max. operating cycles s / h 50
Max. short-circuit protection	315 A, triggering characteristics: gG acc. to IEC/EN 60291-1

Mounting / Installation

Terminals	120 mm ² stranded
-----------	------------------------------

Auxiliary contacts

Rated operational voltage	500 V AC
Rated operational current	6 A
Mechanical data	
Switch	1 NO (ON delayed - OFF leading)
Mounting / Installation	
Terminals	4 mm ² finely stranded wire

Dimensional Drawings (All dimensions in mm) – Subject to alterations

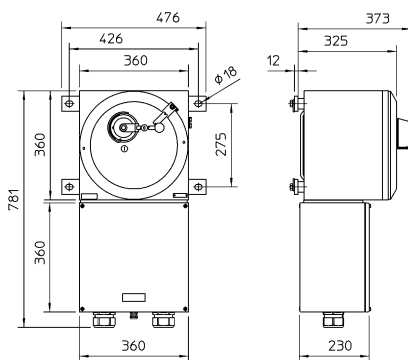

8537/7-712, 250 A, 3-pole

04445E00

We reserve the right to make alterations to the technical data, dimensions, weights, designs and products available without notice. The illustrations cannot be considered binding.