



02076E00

- > Backplane bus for the IS1+ system, consisting of data bus, Ex i PowerBus and address circuits
- > For 2 or 4 modules
- > Installation on 35 mm DIN rails NS 35/15
- > The BusRail can be interconnected for up to 18 modules
- > Passive component with redundancy and high availability











The BusRail is fitted into a 35 mm DIN rail and provides internal electrical connection between the CPU & Power Modules and the I/O modules. The BusRail consists of the internal data bus, the PowerBus and the address circuits for the I/O modules. The internal bus is built up with redundancy. The PowerBus is designed with an extremely high availability.

	ATEX / IECEx						Zone	NEC 505 Class I						Division	NEC 506						NEC 500						
	0	1	2	20	21	22		0	1	2	20	21	22		1	2	1	2	1	2	Class I	Class II	Class III				
Ex interface		x	x		x	x		x	x	x	x	x	x		x	x	x	x	x	x		x	x	x	x	x	x
Installation in		x	x		x ^{*)}	x ^{*)}			x	x		x ^{*)}	x ^{*)}		x	x	x ^{*)}	x ^{*)}	x ^{*)}	x ^{*)}		x	x	x ^{*)}	x ^{*)}	x ^{*)}	x ^{*)}

^{*)} Restrictions see table explosion protection

Selection Table

Version		Description	Order number	Weight
BusRail		for 4 modules	9494/S1-M4	0.100
		for 2 modules begin	9494/S1-B2	0.062
		for 2 modules end	9494/S1-E2	0.062
End cover BusRail		begin	9494/A1-B0	0.044
		end	9494/A1-E0	0.044
End cover with connection cable		0.7 m	9494/L1-V7	0.210
		1.10 m	9494/L1-V8	0.260
		length acc. specification	9494/L1-V9	0.069
DIN rail		For inserting the BusRail (> 0.5 m and < 2 m), 35 x 15 x 1.5 mm (EN 50022)	103714	1.410

Explosion Protection

Global (IECEx)

Gas	IECEx PTB 06.0001X Ex ib IIC T4
-----	------------------------------------

Europe (ATEX)

Gas	PTB 99 ATEX 2222 ⊕ II 2 G Ex ib IIC T4
-----	---

EAC (TR)

Gas	Ex e II U
-----	-----------

Certifications and certificates

Certificates	IECEx, ATEX, Canada (CSA), Kazakhstan (TR), Russia (TR), USA (FM), Belarus (TR)
Ship approval	ABS, BVIS, ClassNK, DNV GL, LR, RS

Technical Data

Types	9494/S1-M4	9494/S1-E2	9494/S1-B2
Number of module slots	4	2	2
Extensible at the beginning	yes	yes	no
Extensible at the end	yes	no	yes
Internal data bus redundant	yes	yes	yes
High availability internal power	yes	yes	yes
Maximum length	3 m, BusRail including connection cable 9494/2.		
DIN rail	For installation of the BusRail, as per EN 50022 (material thickness 1.5 mm / 0.06 in), NS35 /15		
Engineering notes	The BusRail is available in lengths for 2 or 4 modules. End covers are required both at the beginning and at the end. The end covers are available as „BusRail begin“ and „BusRail end“ and with integrated connection cable. The use of the connection cable permits several BusRail segments to be built up in one enclosure.		

Accessories and Spare Parts

Designation	Figure	Description	Art. no.
Designation strips		For BusRail, for 1 BusRail with 16 I/O modules	162793

Dimensional Drawings (All Dimensions in mm / inches) - Subject to Alteration

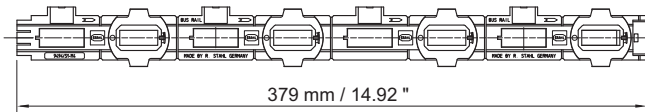

09890E00

BusRail, middle

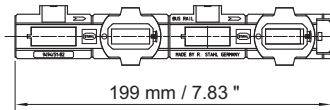

09093E00

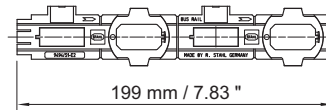

10525E00

BusRail, begin

BusRail, end

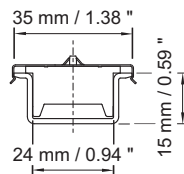
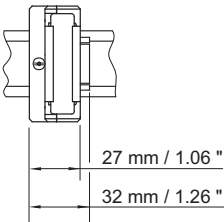
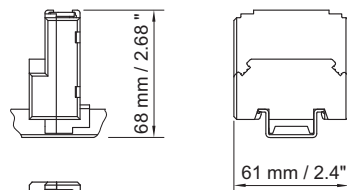

09891E00

09888E00

**End cover BusRail
begin / end**

**Rail for support
similar to EN 50022 NS 35/15**

We reserve the right to make alterations to the technical data, dimensions, weights, designs and products available without notice. The illustrations cannot be considered binding.